

lekkie®

ONENUT USER MANUAL

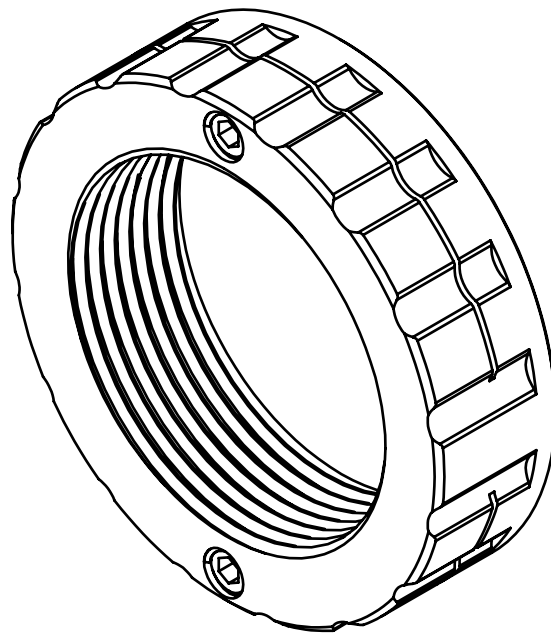

Doc-V2.2

TIPS AND TRICKS

FOR LEKKIE ONENUT
COMPATABLE WITH **BAFANG BBS01/02HD, TRUCKRUN M05**

INCLUDES

- A** 1X LEKKIE ONENUT
- B** 2X M4 GRUB SCREWS

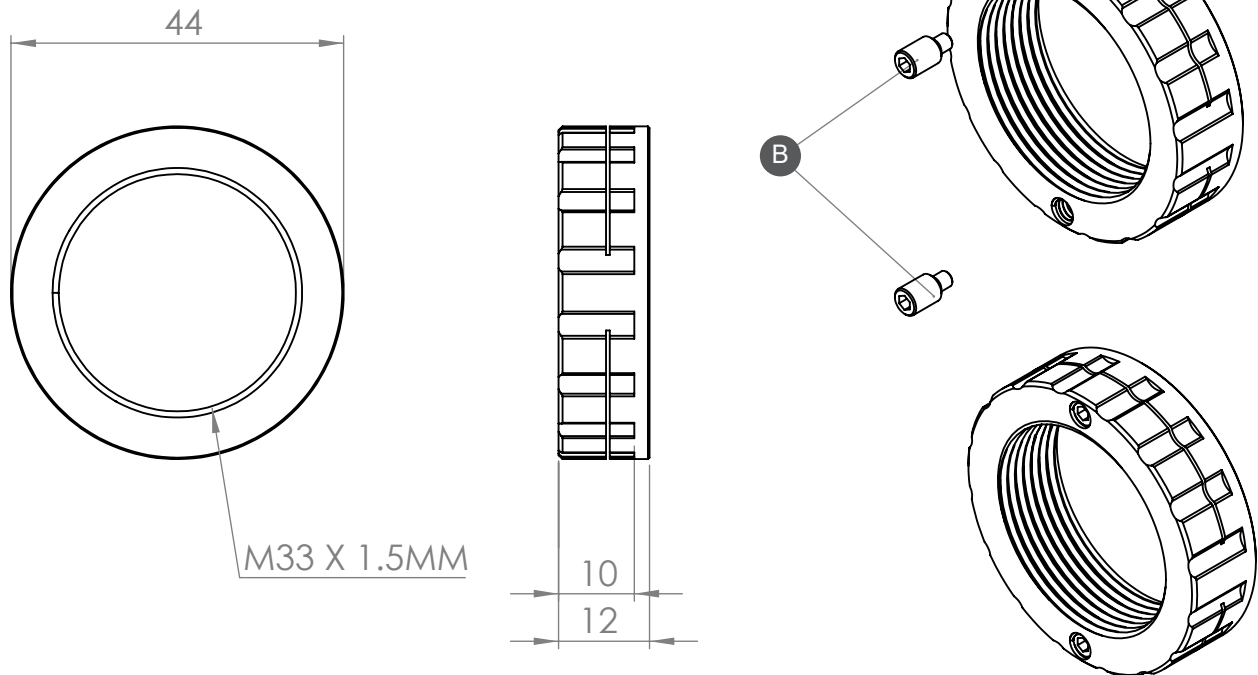

TOOLS REQUIRED

- Lekkie SIXTEEN-44 Socket/16 notch Shimano BB tool (spanner for Shimano 44m 16notch).
- 2mm Hex/Allen Key and torque tool

INSTALL

Before fitting the Lekkie ONENUT make sure the locking plate is mounted correctly with no gaps between the motor and plate. There must be at least 8mm of motor thread extending past locking plate for the ONENUT locking function to work as intended.

A correctly installed plate should never come lose with a ONENUT. Please contact us if you are unsure of your setup.

1. Using the 2mm Allen Key loosen off the 2x Grub Screws so that they can move freely (no need to remove them) and screw the Lekkie ONENUT onto the motor (with the locking plate in place), ensure the teeth on the locking plate engage with the BB Shell*.
2. Tighten the ONENUT up to the recommended Torque setting (50-60Nm) using the Lekkie SIXTEEN-44 Socket or Shimano 16-notch BB tool.

* If a motor has been run loose, the locking plate may have gouged out sections where the teeth contact the BB Shell. If this is the case, the end face of the BB Shell will require re-facing/filing flat so that the teeth can get a good 'bite' into the frame.

3. Lock the ONENUT in place by tightening the 2x Grub Screws to a maximum of 2Nm. Tighten until the Grub Screw feels like it is starting to bottom out then tweak it up slightly, just enough to spread the ONENUT open slightly and lock the thread in place.

Note: If the main thread is not fully engaged, reduce the locking screw torque. A small amount of additional Loctite 243 can be used if required.

4. To remove the ONENUT simply loosen the Grub Screws and unscrew the nut with the 16 notch tool.

WARRANTY

At Lekkie we don't accept anything but the best workmanship and quality. If a part has slipped through our QC system and made it to your hands let us know and we will put it right.

If one of our products fails we want to know so we can make our products better. If you destroy a lekkie product in extreme use tell us. We can learn from this and sell you something to suit your needs.

If you are in any way unhappy with your Lekkie product get in touch so we can put it right.