

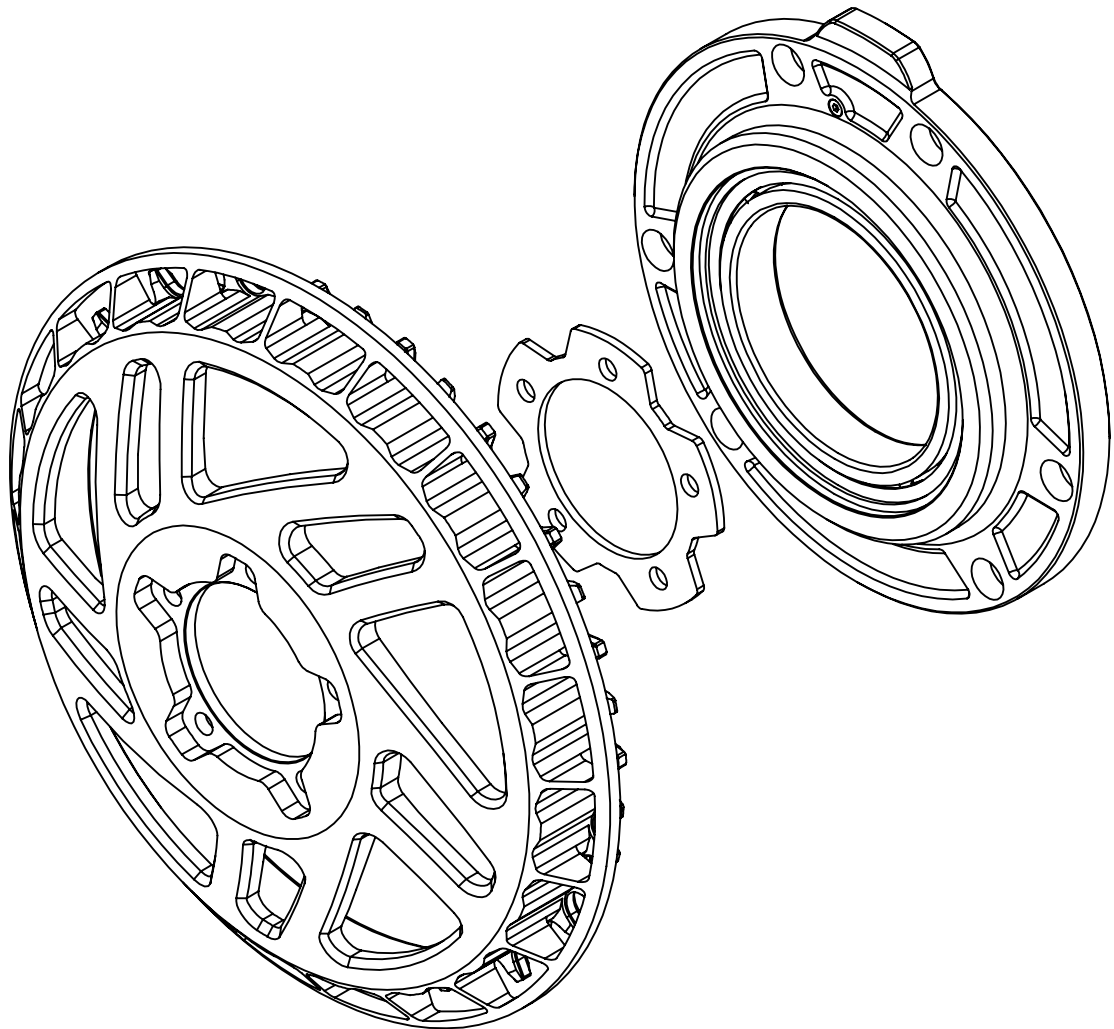

BLINGRING 40T HD

USER MANUAL



Doc-V2.2

PARTS LIST

FOR BLING RING 40T HD PACKAGE
COMPATIBLE WITH **BAFANG BBSHD, M625, M325**

INCLUDES

- A** 1X LEKKIE BLING RING 40T HD
- B** 1X 2MM BLING RING HD SPACER (OR MULTI SPACER FOR V4)
- C** 1X DRIVE COVER HD ASSEMBLY

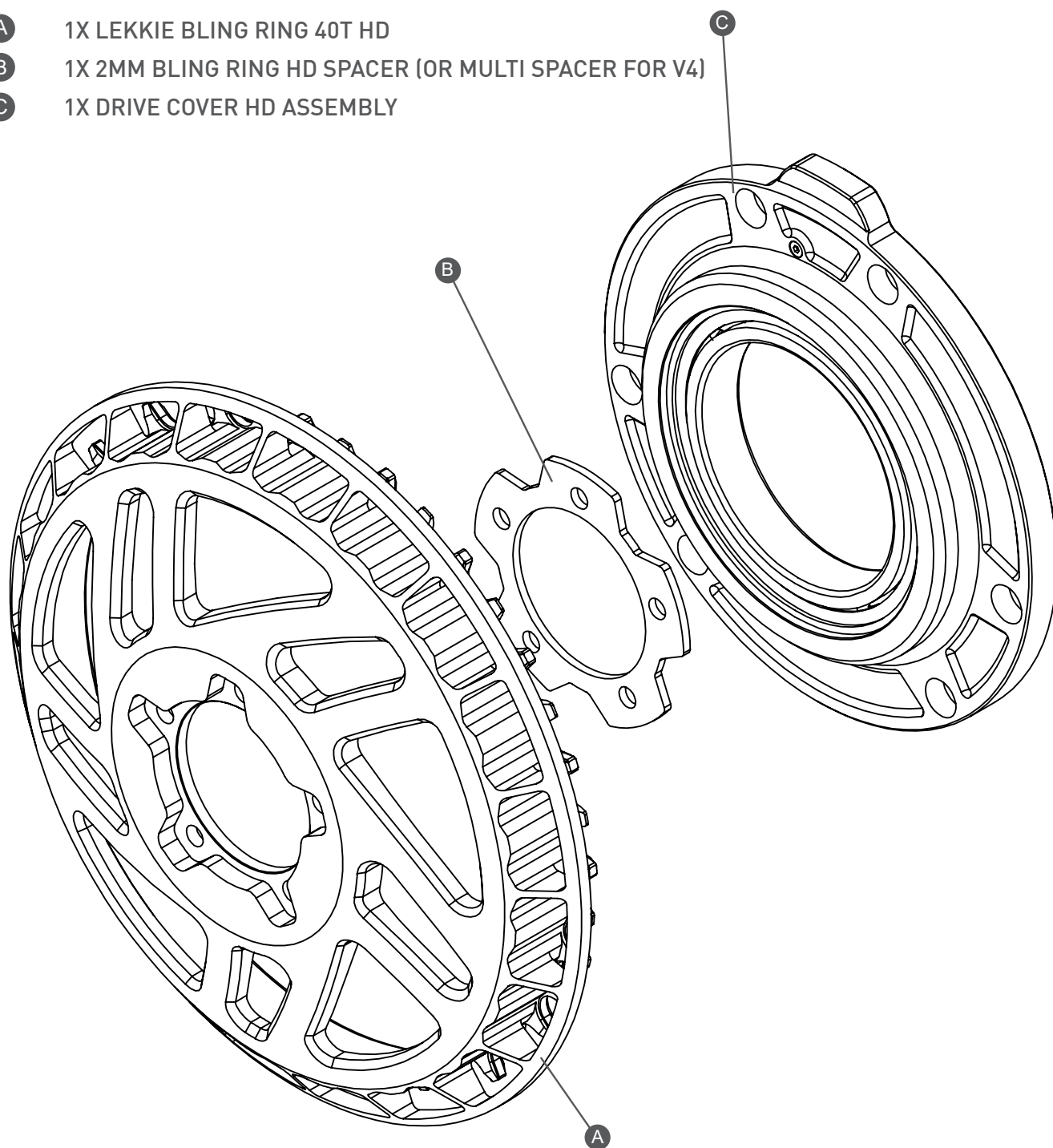

TIPS AND TRICKS

YOU MUST INSTALL THE **LEKKIE DRIVE COVER HD** FIRST

INCLUDES

- A** 1X DRIVE COVER HD V2
- B** 1X MAIN BEARING
- C** 1X GREASE PORT SCREW

NOTE: FOR V2 OR NEWER

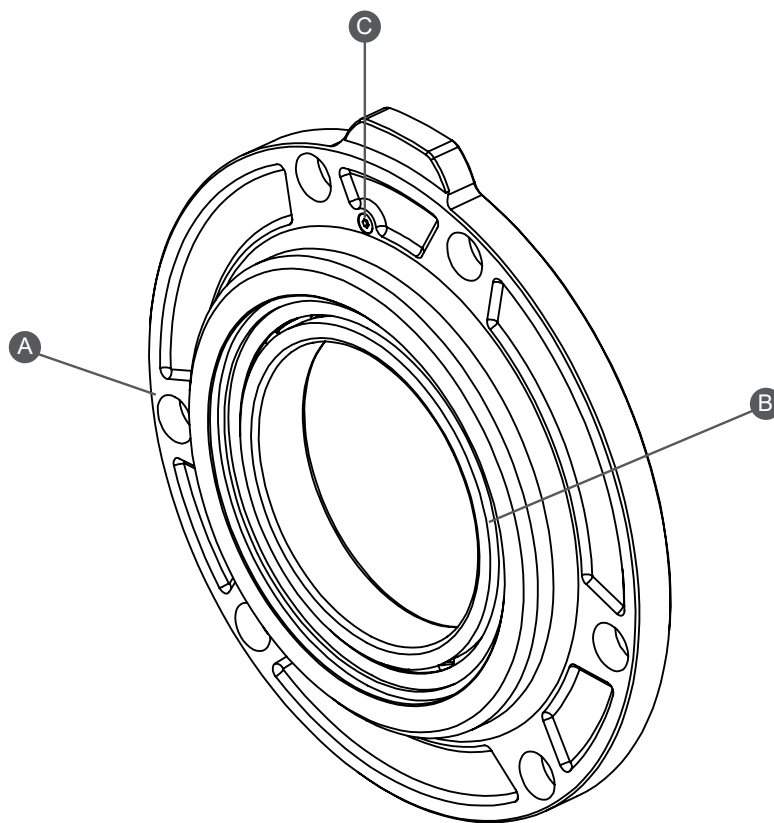

TOOLS REQUIRED

- 8mm hex/Allen key
- 4mm hex/Allen key
- Rubber mallet
- Bearing press
- Moly-grease
- All purpose lithium grease
- High viscosity cassette grease
- Loctite 243
- Scribe/fine tip marker
- Small metal file

When installing the Lekkie Drive Cover HD you will require some tools and some hands on experience with your motor. If you do not the have required tools, confidence or skills to install this take your motor to your local bike shop or engineering shop and they should be able to help you out.

INSTALL TIPS

Here are some tips to keep in mind while completing the install.

- Check paper gasket and replace if damaged.
- When the motor is open check all bearings and replace/re-grease if need be.
- To keep everything running smooth and easy to maintain make sure you grease all metal to metal surfaces.
- Clean any excess grease out of the motor while it is open.
- Clean and grease the main gear and pinion.
- Always grease the axle taper before installing cranks.

DISASSEMBLY

Before you can install the Lekkie Drive Cover HD you need to remove the stock Bafang cover and bearing. This also gives you the opportunity to check the condition of your drive gear, pinion and bearings and replace any parts as needed. It is important to keep the internal components free from dirt/grit, so before opening the housing thoroughly wipe down external surfaces and keep a clean work area to ensure it all goes back together without contamination. The drive cover can be fitted without the need to remove the motor from the bike, however you will need to remove both cranks and the chainring first.

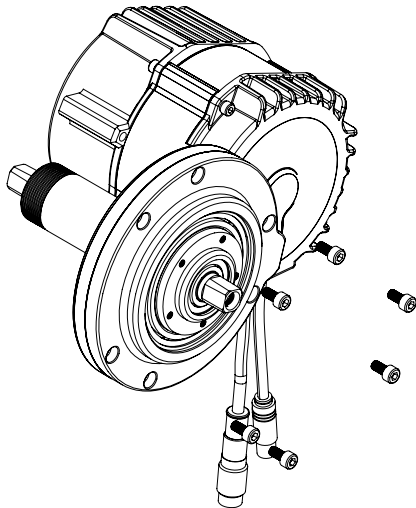

1. Using a 4mm hex/Allen key unscrew the six screws holding on the stock cover and remove.

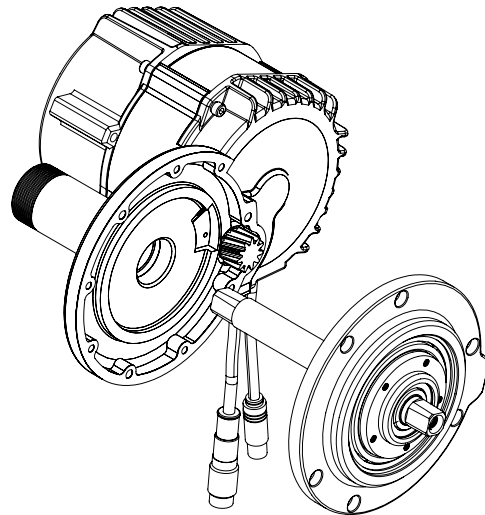

2. Tap the axle from left side of motor, loosening the drive assembly and remove assembly.

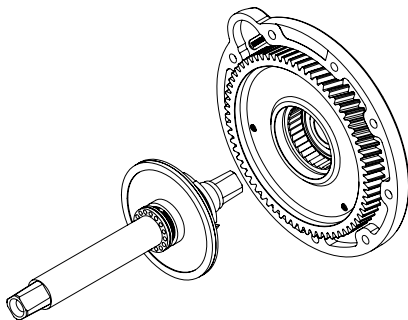

3. Holding the stock drive cover, gently tap the axle from the drive side and pull out the axle assembly.

Note: This will remove the whole axle assembly so be careful not to lose any parts.

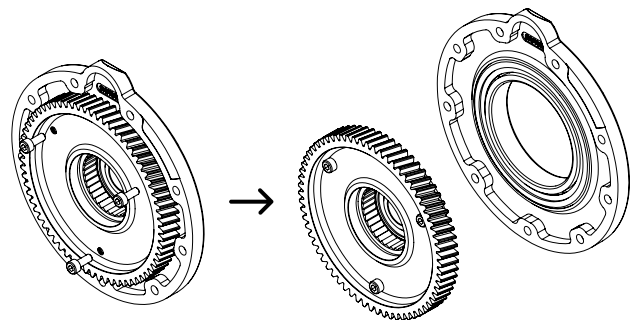

4. Screw 3 M4 screws into the back side of the drive gear until they are touching the bearing. Start turning one screw one turn, then the next screw once, then turn the next screw one turn, then the next. Repeat until the gear is removed.

Note: Occasionally the large bearing comes out of the OEM drive cover. It needs to be removed from the gear Assembly before proceeding.

MOTOR MODIFICATION

To maximise the offset of the 40T Bling Ring, minor motor modification is required. You must complete the motor modification steps or your Bling Ring 40T will grind on your motor, damaging the inside edge of the Bling Ring*.

This modification will require you to file a small amount of material off your motor. When completed correctly the performance and durability of the motor will not be effected.

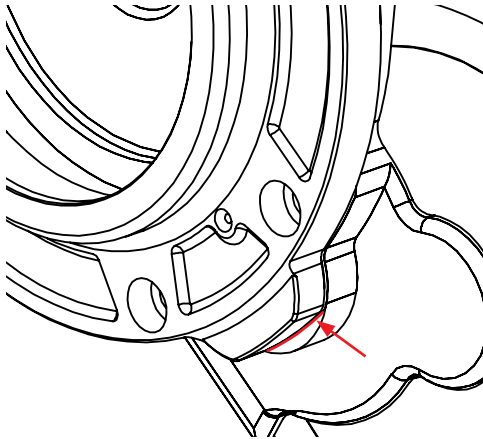

1. Place the Lekkies Drive Cover HD on the motor and mark the edge of the cover, scribing onto the motor housing in the area shown.

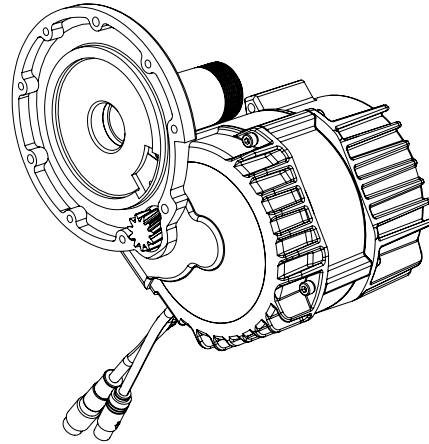

2. Remove the Lekkies Drive Cover HD. Note the scribed mark showing material requiring removal.

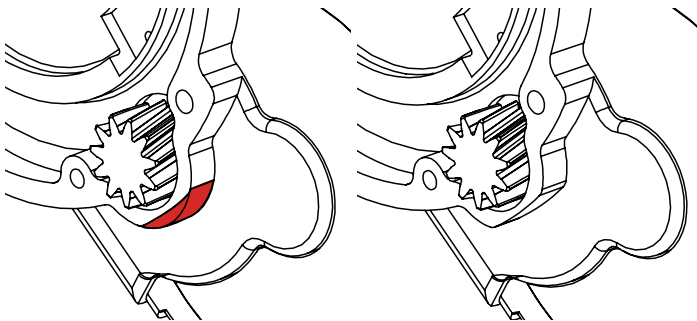

3. Apply tape/masking over the drive gears/opening to avoid metal filing contamination inside the motor.

4. Using a file, carefully remove highlighted material to the scribed line making it the same shape as the Lekkies Drive Cover HD. You may also need to trim the paper gasket.

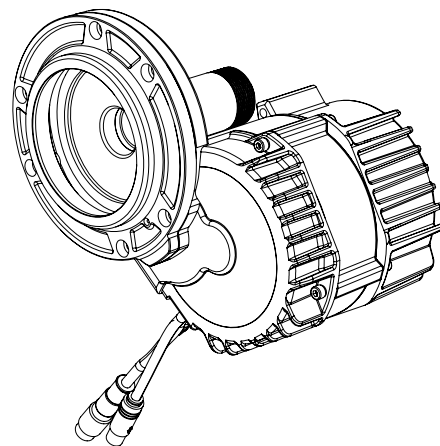

4. Place the Lekkies Drive Cover HD on the motor and check the shape. Repeat previous steps if more material removal is required.

* Damage to the BlingRing caused by running it on a motor without the required modification will void your BlingRing Warranty.

ASSEMBLY

Re-assembly is easy and painless. When re-assembling the motor, make sure you grease all metal-on-metal parts. Do not force any parts and if you are unsure, stop the assembly and contact us.

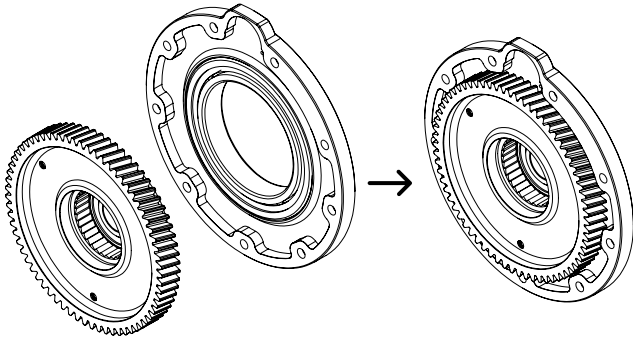

1. Press the main drive gear into the new bearing in the Lekkie Drive Cover HD.

Note: Grease the inner edge of the bearing.

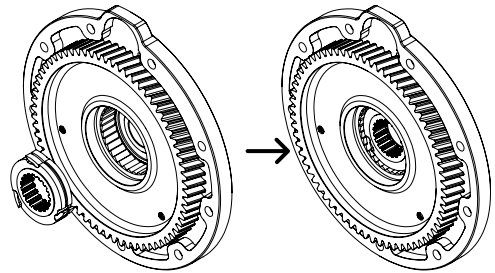

2. Insert the clutch assembly into the drive gear, making sure the pawls are engaging the correct way.

Note: If the motor is well used, check that the Pawls in the clutch move freely and are not worn. You can lubricate the clutch with a light coating of a medium viscosity oil used to maintain cassette freewheels.

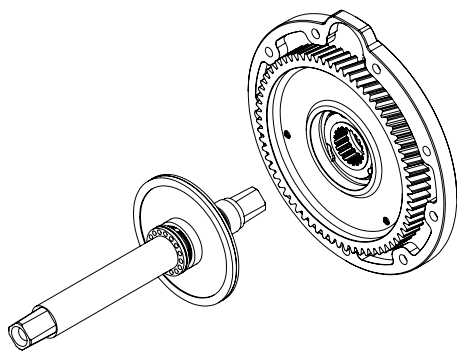

3. Slide the remaining axle assembly in.

Note: Grease all touching surfaces to make maintenance easy.

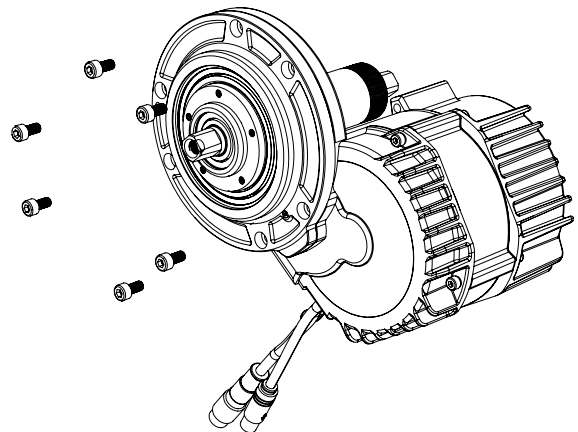

4. Install paper gasket then slide the new drive assembly in. Clean, apply Loctite 243 to threads, and install the six M5 drive cover bolts. Tighten to 6Nm.

Note: Replace gasket if damaged.

GREASE PORT

To keep your motor running its best its important to regularly grease the main drive gear and pinion.

We have added a grease port to the Lekkie Drive Cover HD V2 to allow this.

To do so simply remove the grease port screw and using a grease gun, squirt moly-grease in while slowly turning the motor.

The port is positioned at the junction of the drive gear and pinion.

Note: The grease port is only on V2 or newer.

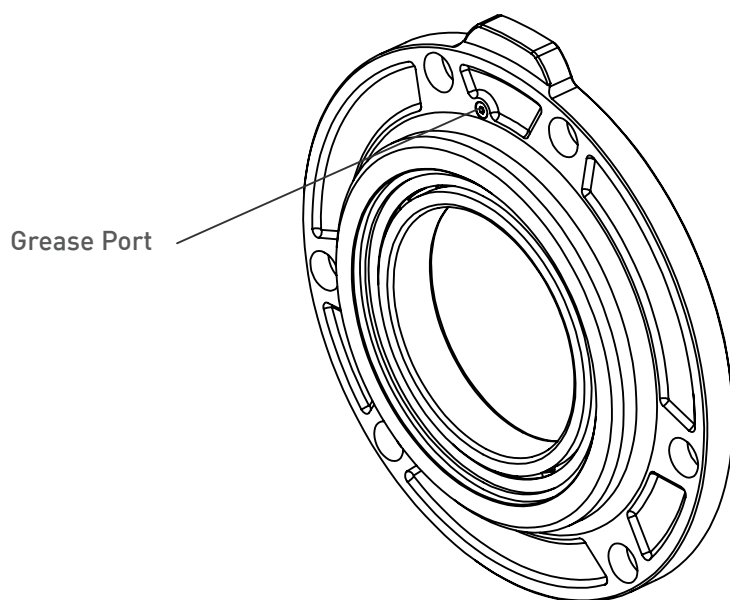

TIPS AND TRICKS

NEXT YOU CAN INSTALL THE **BLING RING 40T HD**

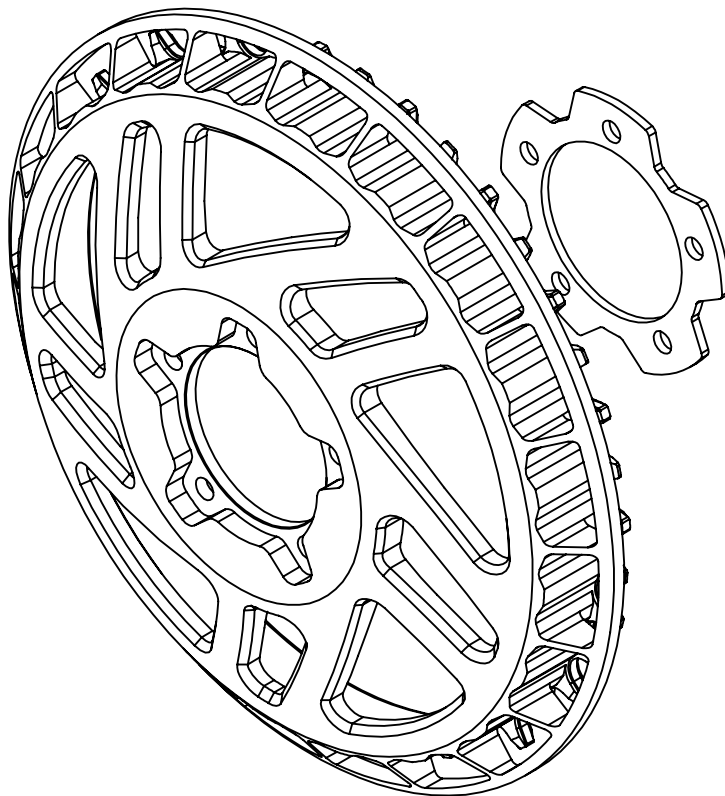

TOOLS REQUIRED

- 4mm hex key

INSTALL TIPS

- Clean and lubricate the axle with a multi-purpose grease before installation.
- Apply Loctite 243 to bolt threads.
- Always install a new chain when installing a new Bling Ring
- If you are offsetting by more than 2mm use longer bolts. (You need to have 5-6mm of thread engagement)
- Make sure when you install your Bling Ring you have at least 1.5mm gap between wide tooth and chainstay to allow flex.
- Tighten to 6Nm
- Try to get the chainline to the centre of your cassette - see below for details.
- Clean and lubricate chain regularly.
- DO NOT use half links in the chain.
- Always grease axle before re-installing cranks.

DIMENSIONS

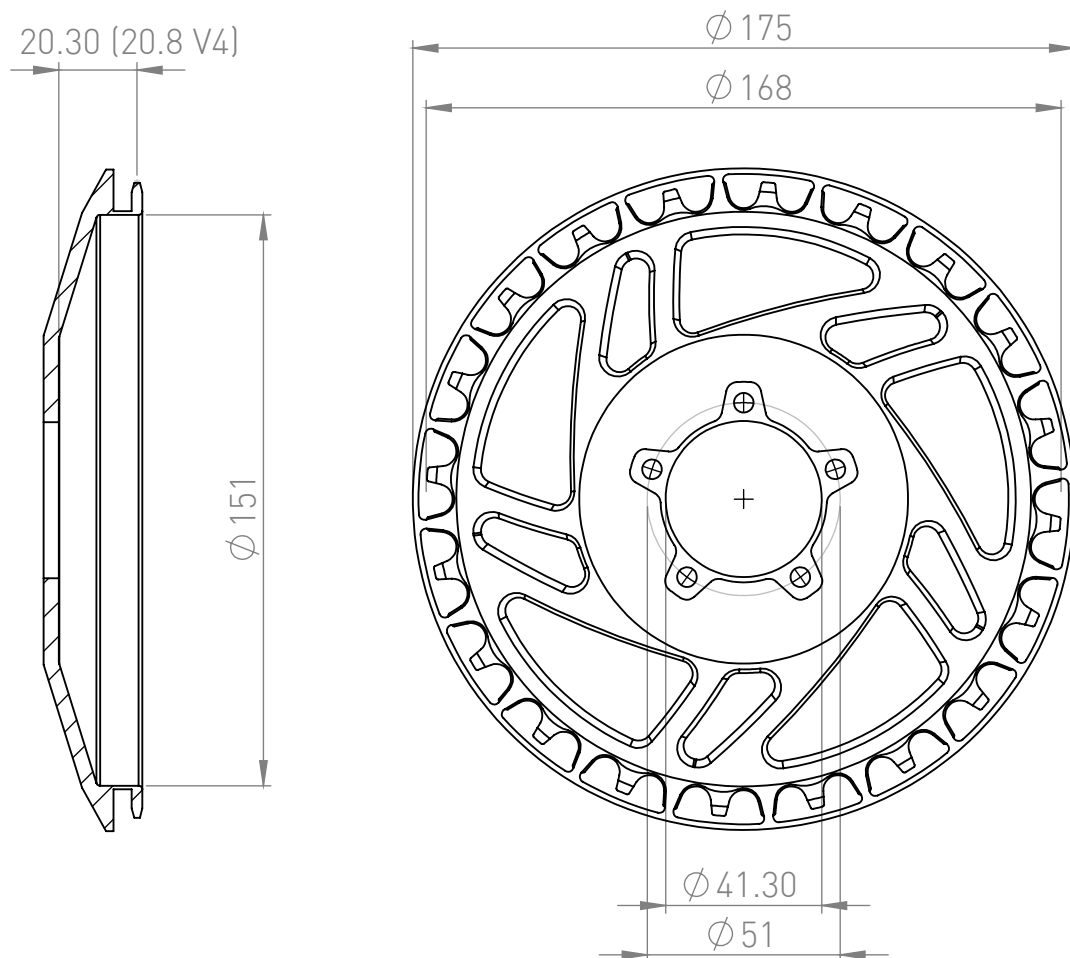

Note the package includes a 2mm Spacer so that you can space the Bling Ring out to the same offset as the original Bling Ring offset.

The additional 2mm offset on the 40T enables users with 73mm BB frames to obtain a better chainline. If you are building a 73mm BB bike try installing without the spacer.

There must be at least 1.5mm gap between the ring and chainstay. On full suspension mountain Bikes ensure adequate clearance at all stages of suspension travel.

CHAINLINE

When building your machine you want to replicate the chainline that was on the bike before you converted it. Ideally you want the chainline to line up with the centre of your cassette.

The Blingring is designed to give you the best possible chainline however sometimes you may need to adjust your offset using spacers to get that chainline perfectly suited to the unique geometry of your build.

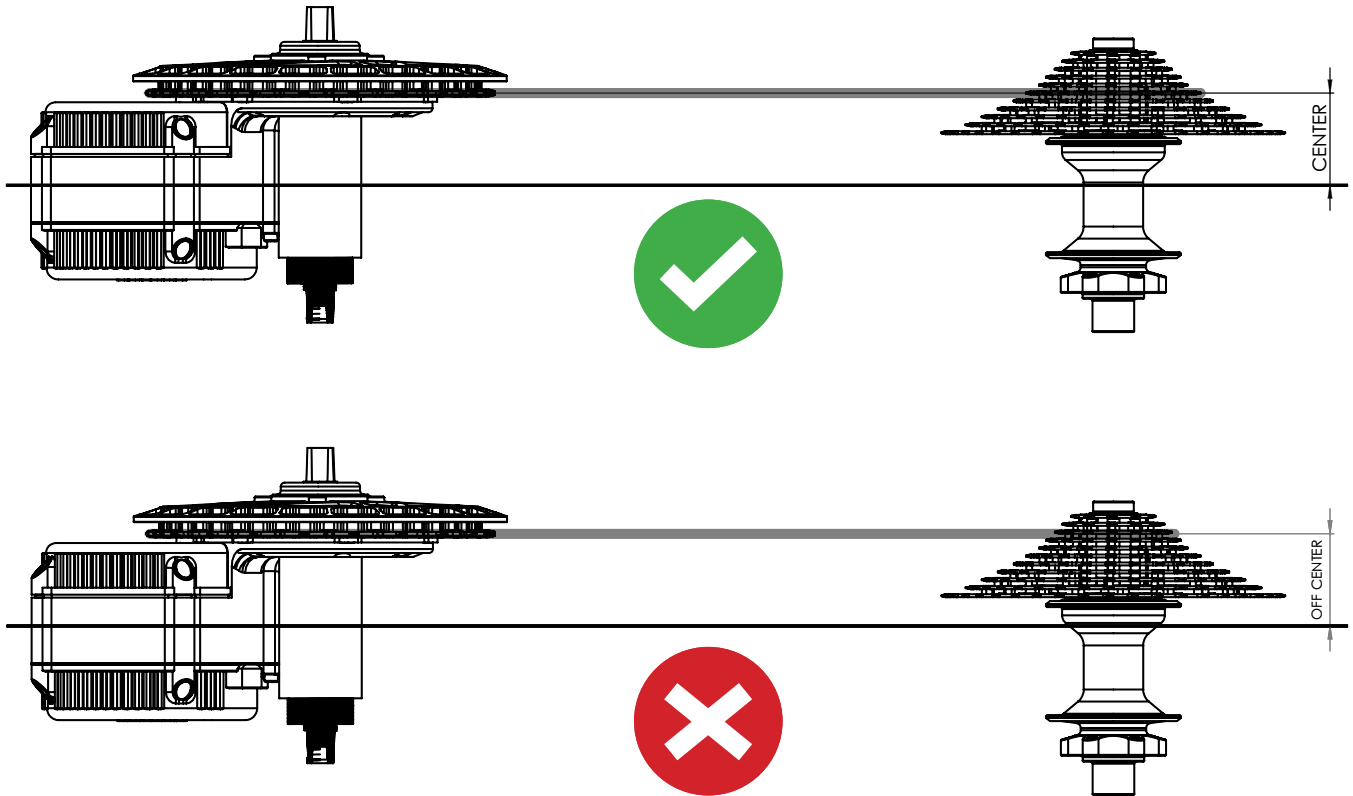

CHAIN COMPATIBILITY

The Lekkie Bling Ring is compatible with most chains. If your chain is not sitting well on the chainring try using a Shimano chain compatible with the number of gears. EG HG-X11 11 Speed.

For 12 speed setups, we advise using the PRO version as it has a narrower tooth cut.

GEOMETRY

Generally the 20mm offset found on the 40T HD BlingRing will give you the best possible chainline without interfering with the motor. However chainstay interference is often the limiting factor. You may need to use Blingring Spacer/s to clear the chainstay.

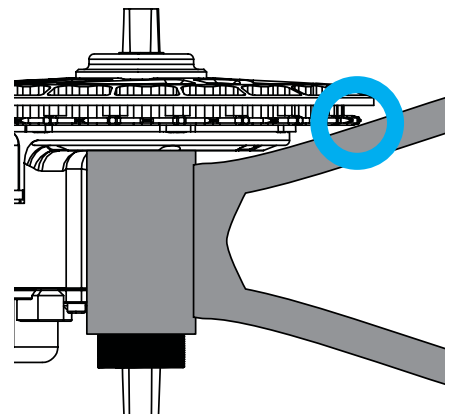

WARRANTY

At Lekkie we don't accept anything but the best workmanship and quality. If a part has slipped through our QC system and made it to your hands let us know and we will put it right.

If one of our products fails we want to know so we can make our products better. If you destroy a lekkie product in extreme use tell us. We can learn from this and sell you something so suit your needs.

If you are in anyway unhappy with your Lekkie product get in touch so we can put it right.